

PRAHRAN HIGH SCHOOL

Opening 2019



PRAHRAN HIGH SCHOOL

The Victorian Government is investing \$25 million to begin development of a new High School on the corner of High and Thomas streets in Prahran.

Prahran High School will provide a standalone co-educational 7-12 school for 650 students and open in Term 1, 2019 with its first cohort of year 7. The school will be built adjacent to an existing educational precinct that includes Melbourne Polytechnic and the National Institute of Circus Arts.

The Building:

The new Prahran High school building will be a modern and exciting place to learn. The building is constructed over four levels with each level having direct access to outdoor learning terraces. A large central atrium runs north – south through the building creating a dramatic focal point for the school community. A series of cascading stairs interconnect the various levels allowing for ease of circulation while also promoting social interaction and physical movement.

The Library, Music and Drama facilities are on Ground Level to take advantage of the large ceiling heights. Science, Art and Food Technology located in the north-west corners of level 01, 02 and 03 to take advantage of the northern aspect with direct access to the outdoor learning terraces. In addition, learning spaces, ICT areas and break out areas are incorporated throughout the building.

Student play areas:

To maintain open play space, the building includes opportunities for passive and active recreation throughout all levels of the building. The Gymnasium is located on the third level with direct access to the outdoor active recreation space and student run café and lounge. Large sectional doors will allow the Gym to be opened up to allow

sporting activities to flow outside. A rooftop passive recreation zone on the fourth level allows students to find quiet learning spaces.

Outdoor terraces located at either end of each floor level provide access to fresh air and sunlight and offer various contained recreation activities such as basketball hoops and gym equipment as well as specialised outdoor learning activities associated with the adjacent specialist subject spaces.

Environmentally Sustainable Design:

Within the school building, the internal walls will have thermal insulation and performance glazing, which reduces the need for conventional energy consumption. The four storey central atrium allows daylight to permeate through each level, which reduces dependency on artificial lighting.

A 20kw solar system will be fixed on the gym roof and rainwater tanks installed in the basement, which allows for 30,000 litres to be retained and reused for toilet flushing and irrigation.

The school will encourage sustainable transport options including public transport, walking and riding. There will be space for close to 100 bikes and the school is located near extensive public transport including two train stations, bus and tram routes.

Enrolment:

Prahran High School will commence with an enrolment for year 7 students only in Term 1, 2019. For more information on enrolment please visit the VSBA website. The school's new Principal will be appointed in early to mid 2018.

Project Timeline

- ✓ **SITE PREPARATION**
Q1, 2017
- **CONSTRUCTION COMMENCES**
Mid 2017
- **PRINCIPAL APPOINTED**
Early to mid 2018
- **CONSTRUCTION COMPLETE**
Q4, 2018
- **SCHOOL OPENS**
January, 2019

The above dates are forecasted only and subject to change.

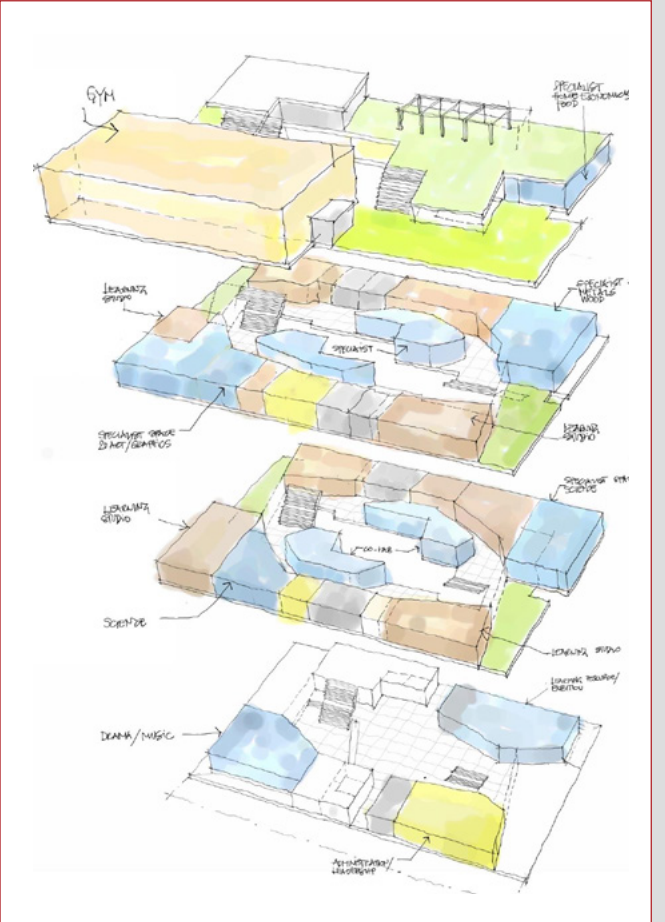



Find out more

You can contact the Victorian School Building Authority via:

Email: vsba@edumail.vic.gov.au

Phone: 1800 896 950

Weekdays from 9am to 5pm

You can also visit the Prahran High School webpage for regular updates at www.schoolbuildings.vic.gov.au



@VICSchoolBuild



/victorianschoolbuild